

**CERTIFIED TRANSLATION FROM THE POLISH LANGUAGE**

*[All the translator's remarks are given in italics in square brackets.]*

**HUAWEI**

Version 02, 16.03.2021

## Manufacturer information

1. Document no.: **HW20210316IP02SUNSPEC**  
HW | yyyy mm dd | IP/DP | version | addressee or reference document
2. Issuer's details: **Huawei Technologies Co., Ltd.**  
 Administration Building, Headquarters of Huawei Technologies Co., Ltd.,  
 Bantian, Longgang District, Shenzhen, 518129, PRC
3. Declaration subject: **PV inverter** (device/component)
- a. Brand

[Logo]  
HUAWEI

a. Series:	SUN2000L	SUN2000MA
b. Models:	SUN2000-2KTL-L1 SUN2000-3KTL-L1 SUN2000-3.68KTL-L1	SUN2000-3KTL-M0/-M1 SUN2000-4KTL-M0/-M1 SUN2000-5KTL-M0/-M1 SUN2000-6KTL-M0/-M1 SUN2000-8KTL-M0/-M1 SUN2000-10KTL-M0/-M2 SUN2000-12KTL-M0/-M2 SUN2000-15KTL-M0/-M2 SUN2000-17KTL-M0/-M2 SUN2000-20KTL-M0/-M2
c. Firmware:	SUN2000L V200R001C00SPCXXX	SUN2000MA V100R001C00SPCXXX
d. Supported SunSpec models	<i>001 - Common Model 101 - Single Phase Inverter Model (Integer+SF) 120 - Inverter Controls Nameplate Ratings 121 - Inverter Controls Basic Settings 122 - Inverter Controls Measurements and Status 123 - Inverter Controls Immediate Controls 126 - Inverter Controls Static Volt-VAR Arrays 127- Freq-Watt Param</i>	<i>001 - Common Model 103 - Inverter(Three Phase) 120 - Inverter Controls Nameplate Ratings 121 - Inverter Controls Basic Settings 122 - Inverter Controls Measurements and Status 123 - Inverter Controls Immediate Controls 126 - Inverter Controls Static Volt-VAR Arrays 127- Freq-Watt Param</i>

**4. Information content:**

These devices support the SunSpec Modbus standard (protocol standard) and the RS485 transmission standard.

5. **Configuration:** The protocol standard used can be changed via the FusionSolar APP or the SUN2000 APP, according to the operating instructions: **The main menu / Settings / Communication configuration / RS485 settings / Protocol type / Sunspec**

Modbus SunSpec registers responsible for remote control of the inverter and active power control:

Number (decimal)	Description	CNT	Type	Access
40232	Connection control / Remote shutdown	1	uint16	RW
40233	Active power setpoint	1	uint16	RW

On behalf of Huawei Technologies,  
 Warsaw, 16.03.2021,

*[illegible signature]*  
 Szymon Witoszek  
 Senior Solution Manager  
 Solution Sales & Marketing, CEE & Nordic

# HUAWEI

## Information appendix to the declaration: HW20210316IP02SUNSPEC

### "Change of protocol standard for RS485 interface"

#### Screenshots from the SUN2000 application (EN)

#### Procedure description

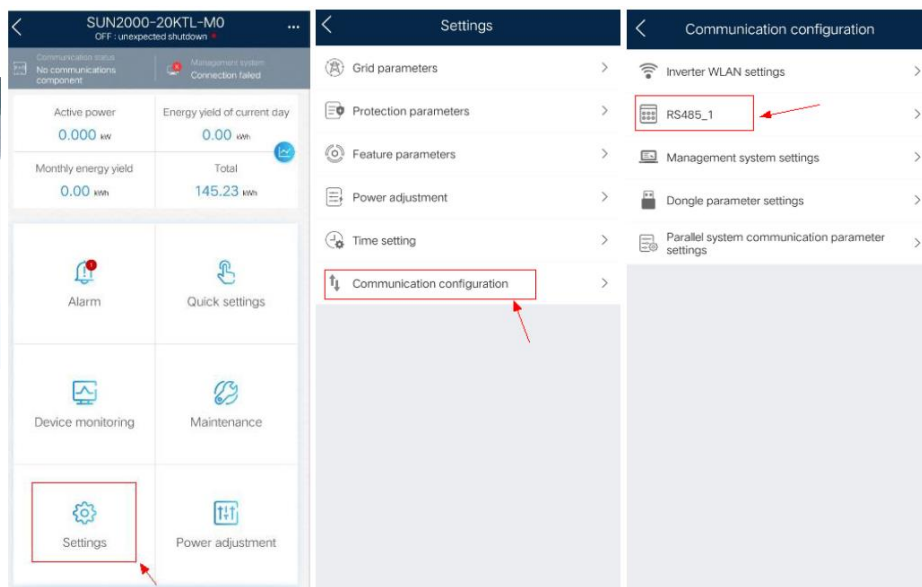

1/ Log in to the application as an installer.

2/ From the main menu, select **[Settings]**

3/ Select **[Communication configuration]** from the **[Settings]** menu

4/ Select **RS485\_X** from the **[Communication configuration]** menu

5/ From the **[RS485\_X]** menu, select **[Protocol type]**

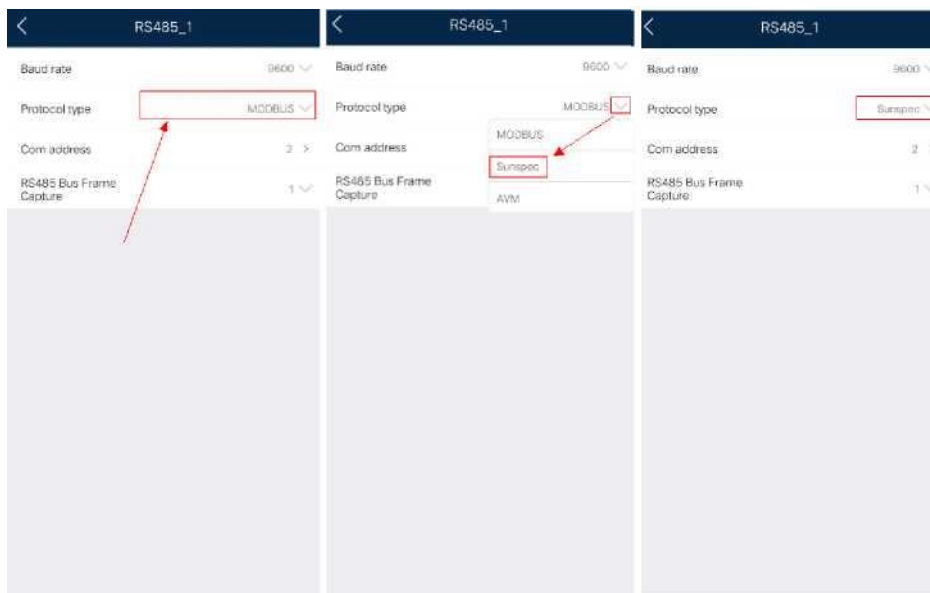

6/ Select the appropriate protocol standard from the drop-down menu **[Sunspec]**

7/ Once the protocol standard has been selected, it will be displayed in the **[RS485\_X]** menu.

I hereby certify that the above translation of the text corresponds to the electronic document in Polish.

Aleksandra Bacz, a sworn translator of English entered in the Register of Sworn Translators kept by the Minister of Justice, under number TP/2/18.

Number in the Sworn Translator's Register: 370/2023

Gliwice, 15 May 2023

Signed with the use of a certificate issued for Aleksandra Maria Bacz (qualified certificate).

Created on: